

Public Building Commission - CHS Concession Stand Subcommittee Meeting
January 11, 2017 Meeting Minutes
Cheshire High School, 525 South Main Street – Facilities Department Offices

Members Present: Richard Clavet, Chairperson
Vincent Robitaille

Others Present: Vin Masciana, Cheshire Public Schools
Dan Marseglia, Cheshire Public Schools
George Noewatne, Director of Public Works and Engineering
Mark Nash, PBC Chairperson
Vinnie Sita, Cheshire Public Schools
Jim Pino, Olympus Construction
Ken Grant, Olympus Construction
Ryan Haley, Silver Petrucelli + Associates

The meeting began at 7:50 AM. A quorum was determined to be present.

The project was discussed:

- 1.3 The sewer line was scoped and no blockages are apparent.
- 1.4 Vin M is waiting for a response re: the final location of the donor walk.
- 1.8 Additional heaters may be added to the “running list once the final numbers are available.
- 1.9 A Request for Proposal for the kitchen equipment package was just issued by S/P. Jim will review and solicit vendors for pricing. Ryan was unsure whether Chesprocott officials had approved the specific plan, although they are aware of the overall intent of Concession Stand portion of the project, as they requested the additional sink. The new plans may be sent to them as a courtesy.
- 2.1 There was an email out (not received by Olympus) on the fire suppression for the hood system. Concerns for building winterization were discussed. Discussions on possibly adding heat (as per the Bid Alternate or otherwise) were discussed., vs. changing the canister yearly to prevent freeze ups. No decision was reached.

NEW BUSINESS

- 4.1 Discussion on door keying took place. Vin S asked that all of the doors be keyed alike with a separate key for the utility room. It was determined that there will be no need to contact the schools locksmith, as this building will be keyed independently from the rest of the school.

Motion to adjourn made at 8:15 AM by Vin Robitaille and seconded by Rich Clavet. The motion carried with a unanimous vote.

The next meeting will be Wednesday, January 25, 2017, at 7:45 AM.
Respectfully submitted,



George Noewatne, Director of Public Works and Engineering

OLYMPUS CONSTRUCTION		11-Jan-17
77 Cherry Street		
Milford, CT 06460		
203-878-1544		
PROJECT: CHESHIRE HIGH SCHOOL CONCESSION STAND AND TOILET ROOMS		
Olympus	Item	Price
<u>Control#</u>	<u>Description</u>	<u>or Budget Amt</u>
199-01	Additional Door Louvres at Doors 103,104,105 per SDI-01	\$ 1,442.10
199-06	Additional Hand Sink Requested per PSK 100-01	\$ 2,431.00
199-10	Unforeseen Additional Concrete Removed	\$ 2,106.80
199-11	Credit for Tree (not replanting) note: stump still removed	\$ (650.00)
	Additional Cost for Temporary Heat if/as necessary	?
	Add Alternate 5 (unit heaters - to be reviewed/confirmed)	\$ 17,000.00
	Kitchen Equipment Package	?

KITCHEN EQUIPMENT SCHEDULE		
SYMBOL	DESCRIPTION	MFR / MODEL NUMBER / REMARKS
E1	36" 6-BURNER RANGE	CPG 36-CP3V-68-526
E2	GAS GRIDLE (FLA TCP)	STAR MFG. STAR-MAX 636TIF (SEE NOTE #2)
E3	GAS CHAR-BROILER	STAR MFG. STAR-MAX LAVA ROCK 6C36 CBF (SEE NOTE #2)
E4	GAS FLOOR FRYER	AVANTICO. FACC WIT- 2663TII COVER
E4U	GAS FLOOR FRYER (ALTERNATE)	RTCO. SEHSBR WITH COVER (ALTERNATE TO E4)
E5	REFRIGERATOR	TRUE FOOD SERVICE EQUIP. T-23-HC
E6	FREEZER	TRUE FOOD SERVICE EQUIP. T-23R-1C
E7	BEVERAGE COOLER/MERCHANDISER	TRUE FOOD SERVICE EQUIP. 5D7-45-LD (SEE NOTE #6)
E8	3-COMPARTMENT POT SINK	ADVANCE TABCO. 94-63-34-18L
E9	1-COMPARTMENT PREP SINK	ADVANCE TABCO. 94-71-2C
E10	HAND WASH SINK (5'x6')	ADVANCE TABCO. 7PS-25 (INCLUDES FAUCET)
E10	HAND WASH SINK (5'x5')	ADVANCE TABCO. 7PS-23 (INCLUDES FAUCET)
E11	COMMERCIAL KITCHEN EXHAUST HOOD	GREENHECK. 6SEV (SEE MECH. SCHEDULE ON DWG. M300)
E12	HEATED HOLDING CABINET	"METRO. C539-HFC-U
E13	HOT WATER DISPENSER	HATCO. AWD-12 (SEE NOTE #2)
E14	WORK TABLE 24' x 96"	ADVANCE TABCO. 1B-248 (WITH 1/2" 5-24-96 HD-SHELF)
E15	WORK TABLE 30' x 48"	ADVANCE TABCO. 1T6-304 (ABOVE ARGJ)
E16	5" ORANGE CABINET 24' x 48' x 63"	FOCUS FOODSERVICE FFD-55C34484 (SEE NOTE #7)
E17	48" WIDE MENU BOARD	SELECTED & PROVIDED BY OWNER
E18	ICE MACHINE (55W x 30")	EXISTING UNIT PROVIDED BY OWNER
E19	COAT HOOKS	BRADLEY CORP. MODEL 9848 (6-HOOKS @ 60" LONG)
E20	POT SINK FAUCET	TES B-284 WITH 3-OC44-R & 3-0107
E21	PREP SINK FAUCET	TES B-0231
E22	EQUIPMENT TABLE 30' x 72"	ADVANCE TABCO. 755-306 WIT- 7A-30 SIZE SPLASH (NOTE #6)
E23	EQUIPMENT TABLE 15' x 30'	ADVANCE TABCO. 755-305 (TABLE FOR E19)

KITCHEN EQUIPMENT NOTES:

1. UNDER THE BASE BID SCOPE OF WORK, THE CONTRACTOR IS RESPONSIBLE FOR PROVIDING PLUMBING, ELECTRICAL & MECHANICAL SERVICES FOR LISTED EQUIPMENT - REFER TO "MEP DRAWINGS FOR MORE INFORMATION & COORDINATE WITH THE APPROVED EQUIPMENT PACKAGE
2. EQUIPMENT STAND OR TABLE REQUIRED FOR MOUNTING EQUIPMENT.
3. SHELVING (WALL & FLOOR) AND DRYING RACKS SHALL BE PROVIDED BY OWNER.
4. REFER TO KITCHEN EQUIPMENT PLAN FOR QUANTITIES OF EQUIPMENT.
5. FOR EQUIPMENT NOTED 3.1, NOT SHOWN GRAPHICALLY ON PLAN, PROVIDE QUANTITIES SHOWN AND COORDINATE LOCATION WITH OWNER.

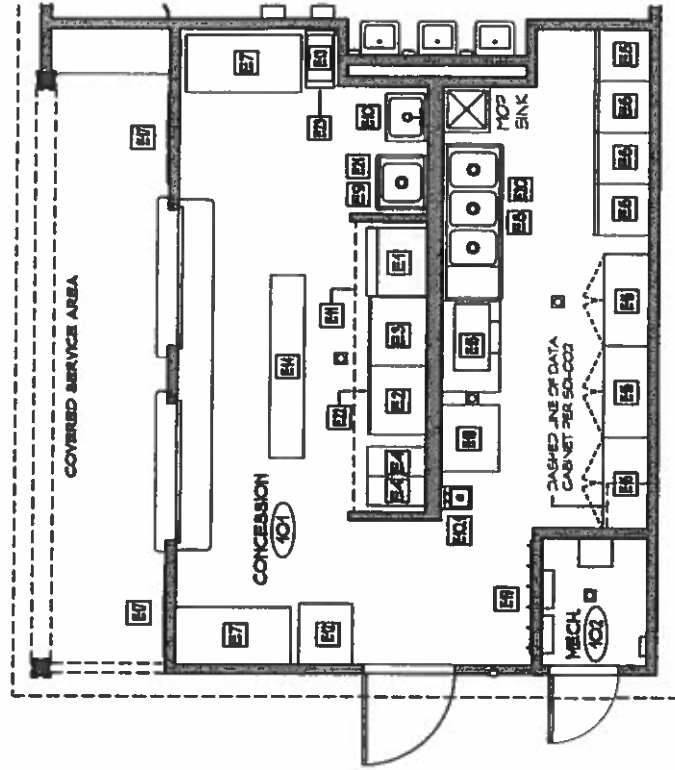

CONCESSION STAND
KITCHEN EQUIPMENT PLAN

SCALE: 3/16" = 1'-0"

1
A102

6. BEVERAGE COOLER/MERCHANDISER EQUIPMENT WILL BE PROVIDED BY COCA-COLA
7. PROVIDE MOBILE SECURITY ENCLOSURE BY PFS AS A COMPLETE KIT WITH ALL PANELS, POSTS, CASTERS & SHELVING.
8. EQUIPMENT TABLE E22 IS INTENDED TO SERVE AS MOUNTING SURFACE FOR E2 & E3 EQUIPMENT - CONFIRM WITH MANUFACTURER THAT SPECIFIED SIZE FOR E22 MODEL IS SUFFICIENT TO ACCOMMODATE E2 & E3 EQUIP.

ASK
102-01

Kitchen Equipment Plan &
Schedule (Revised) SDI-003

SLVIA/PTINIGLIU + ASSOCIATES

Cheshire High School Concession Stand
525 South Main Street
Cheshire, Connecticut 06410