

RECEIVED  
Town of Cheshire  
FEB 19 2021

Planning Dept.

Cheshire Planning & Zoning Office  
Inland Wetlands and Watercourses Commission  
84 South Main Street  
Cheshire, CT 06410

February 18, 2021

Re: Request For Determination Letter For Shed Installation

To Inland Wetlands and Watercourses Commission:

I applied for a permit to cut down trees along my driveway and backyard on April 3, 2019. The permit was approved in 2019. As I do not have a garage on my property, I would like to request to install a shed alongside the driveway of my property.

I would like to install a two story, 16' x 20' x 18'3" shed alongside the driveway. I have cut down trees that were permitted in the designated area and currently, there is space to potentially install a shed.

The shed would not be situated on any undisturbed wetland soil. It will be installed on concrete foundation blocks set on the ground therefore no excavation of any type is needed. I have enclosed a photo of the shed dimensions and its location on a map.

The shed would be used to store bicycles, a lawnmower, a snow-blower, two wheel barrows, and gardening tools such as shovels and rakes. It will be installed by Tuff Shed, an authorized service provider of The Home Depot.

I appreciate the time and understanding from the commission board to evaluate my request in installing a shed along the driveway on 195 Lanyon Drive. Cheshire, CT.

Thank you,

  
Shorab Hossain

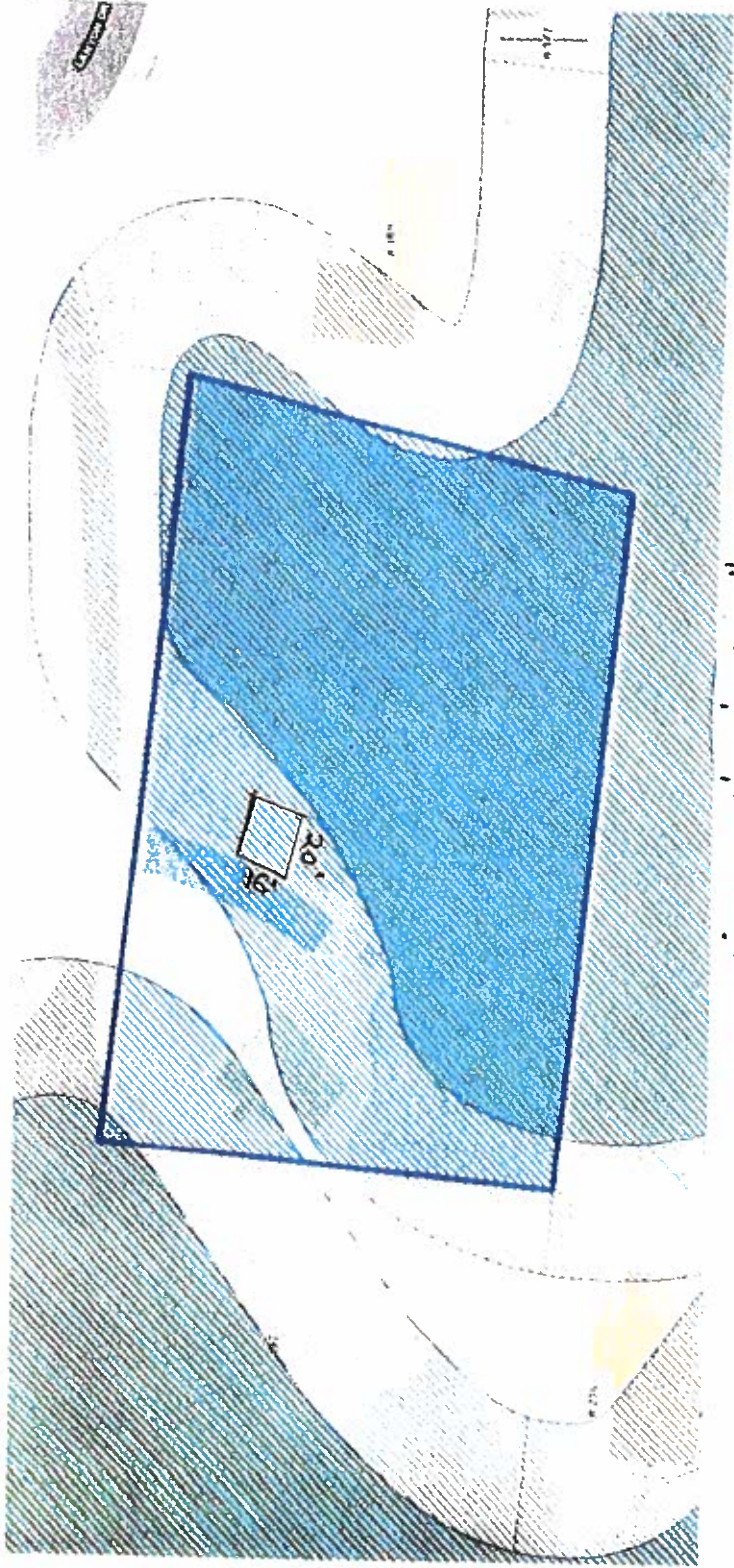

SHEED DIMENSIONS: 16' x 20' x 18'-3"  
2 STORY STORAGE SHED