

Public Building Commission  
January 30, 2013 – 5:00 pm  
Cheshire High School Tunnel Reparation Committee  
Town Hall, Room 210

Members Present: Mr. Art Crooker, Committee Chairman  
Mr. Mark Nash, PBC Member  
Mr. Joe Barba, PBC Member

Others Present: Mr. Dan Marseglia, Cheshire Public Schools  
Mr. Vincent Masciana, Cheshire Public Schools  
Ms. Judy Masella, Cheshire Public Schools  
Mr. George Noewatne, Cheshire Public Works  
Mr. Adam Weissman, GeoInsight

The Chair called the meeting to order at 5:00 p.m. Roll was called and it was determined a quorum was present.

Mr. Weissman reviewed the courtyard work performed last summer.

Mr. Weissman stated that the work planned for summer 2013 is as follows:

1. Drainage installation on perimeter walls of the senior courtyard (see attached drawing).
2. Underground piping of roof leaders that discharge into courtyard (see attached drawing).

GeoInsight has the bid documents ready to incorporate into the Town's standard bid package.

Once the drainage work is completed, humidity in the tunnels can be monitored and a decision on dehumidification made based on the actual conditions. The target is to have bids received prior to the April 3, 2013 PBC meeting.

GeoInsight would like to gather tunnel humidity and temperature data while the heat is still on. This will provide "before" data for analysis of the effectiveness of the future drainage installation.

*Motion by Mr. Nash to fund data loggers to investigate tunnel humidity and temperature conditions, not to exceed \$3,500. Motion seconded by Mr. Barba and passed unanimously.*

*Motion by Mr. Barba to recommend the PBC approve GeoInsight's design and submit it to the Town Council for approval to bid. Motion seconded by Mr. Crooker and passed unanimously.*

*Motion by Mr. Barba to adjourn. Motion seconded by Mr. Crooker and passed unanimously. Meeting adjourned at 5:55pm*

Submitted by:

  
George Noewatne

6 INCH ROOF LEADER DRAINAGE PIPE  
 INSTALLED MINIMUM OF 42" BELOW  
 DRAIN TO MANHOLE

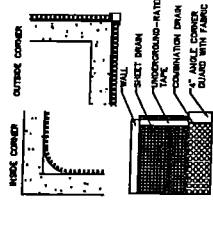

FOLD BACK EDGE OF FABRIC ON LOWER DRAIN (DO NOT DETACH FROM CONES OF UPPER DRAIN). OVERLAP FABRIC OF LOWER DRAIN, SEAL WITH SURROUNDING RATED TAPE.



OVERLAP FABRIC IN DIRECTION OF WATER FLOW. USE TAPE OR BRAY ADHESIVE TO SEAL JOINT AT BACKFALLING. ALL EDGES OF FABRIC MUST BE TUCKED BEHIND CORE EDGE TO PREVENT SOIL FROM ENTERING CORE.

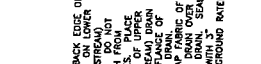

4" PERFORATED DRAIN AT BASE OF TRENCH



OVERLAPPING TOTAL DRAIN

GOING AROUND CORNERS

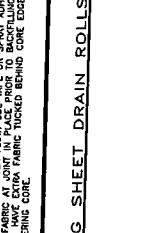

ATTACHING SHEET DRAIN ROLLS

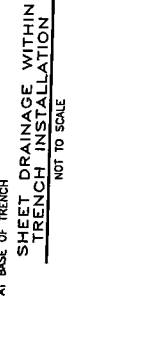

ATTACHING SHEET DRAIN ROLLS

OVERLAPPING TOTAL DRAIN

NOT TO SCALE

OVERLAPPING TOTAL DRAIN

NOT TO SCALE

OVERLAPPING TOTAL DRAIN

NOT TO SCALE

OVERLAPPING TOTAL DRAIN

NOT TO SCALE

NOT TO SCALE

NOT TO SCALE

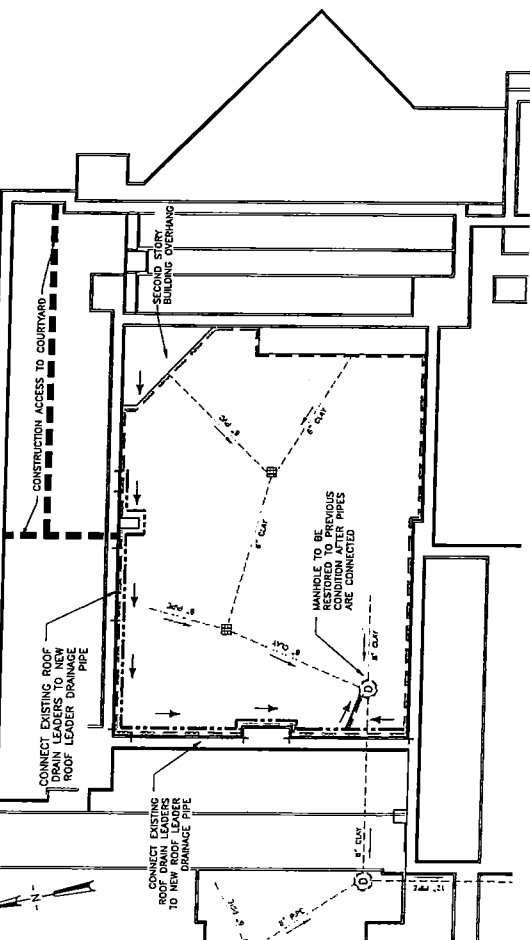

SENIOR COURTYARD SITE PLAN

- LEGEND**
- ☐ EXISTING CATCH BASIN
  - ⊙ EXISTING MAN HOLE
  - LOCATION TO INSTALL SHEET DRAINAGE SYSTEM, PERFORATED DRAIN AND WATERPROOF MEMBRANE ALONG FOUNDATION/FOOTING WALL
  - LOCATION TO TRENCH AND INSTALL SHEET DRAINAGE SYSTEM AND PERFORATED PIPE
  - LOCATION TO INSTALL ROOF LEADER DRAINAGE PIPE
  - DIRECTION OF FLOW IN INSTALLED DRAINAGE PIPING
  - ACCESS ROUTE ARE 70 INCHES WIDE X 82 INCHES HIGH
  - DIRECTION OF FLOW IN EXISTING DRAINAGE PIPING
  - +
  - LOCATION OF ROOF DRAIN LEADER (APPROXIMATE)

**NOTES:**  
 1. THIS DRAWING WAS BASED UPON BASE MAP PROVIDED BY BL COMPANIES, DATED OCTOBER 12, 2009.  
 2. LOCATION AND DEPTH OF SITE FEATURES BASED UPON SITE INVESTIGATIONS, FACILITY INTERVIEWS, AND EXISTING SITE DRAWINGS